

Date:		Customer:	
Project Name:		Contact:	
Location:		Engineer:	
Revision:		Architect:	
Prev. Revision:		G C:	
Tag#:		Mech:	

QTY.	Ventacity Model No.	Description
	VS250 CMh	250 CFM Ceiling Mounted HRV
	VS250 CMe	250 CFM Ceiling Mounted ERV
	VS250CM-DAMP-SET	External Damper Module Set (Inlet & Outlet)
	VS250CM-DX	External DX Postheater Module
	VS250CM-WCO	External WCO Postheater Module
	VS-CO2-INT	Internal CO2 Sensor*
	VS-PUMP	External Condensate Pump
	VS-SIPHON	External Condensate Ball Siphon

*For room CO2 sensors, go to ventacity.com/resources for suggested suppliers

NOTE: For the **SBC100 Submittal**, go to ventacity.com/resources

General Notes:

- This submittal is for approval. Approval is required in order for equipment to be released for sale.

Contractor Notes

_____ Sign	_____ Date
<input type="radio"/> Approved as Noted <input type="radio"/> Approved with Comments <input type="radio"/> Revise and Re-Submit	

SPECIFICATIONS

Flow Rate	60 - 270 cfm / 102 - 459 m ³ /h	Increments: 15 cfm / 25.5 m ³ /h
Max. External Static Pressure	2.0 inch W.C. / 498 Pa	
Exchanger Efficiency (AHRI 1060)	HRV: 91.2% Sensible	ERV: 85.7% Sensible; 75.9% Latent; 82.3% Total
Temperature Conditions	Outdoor: -22° to 104° F / -30° to 40° C	Ambient: 41° to 104° F / 5° to 40° C
Max. Return Air Humidity	90%	
Dimensions (L x D x W)	30.7" x 12.2" x 46.9" / 0.780 m x 0.31 m x 1.19 m	
Shipping Dimensions (L x D x W)	39" x 18" x 59" / 0.99 m x 0.46 m x 1.5 m	
Weight (Shipping)	HRV: 154 lbs / 70 kg (Shipping: 197 lbs / 89 kg) ERV: 159 lbs / 72 kg (Shipping: 204 lbs / 93 kg)	
Fans (EC, Variable Speed Control)	Plastic Impeller; 3653 RPM; IP54	
Filters	Outside Air: MERV13 (11.2 x 9.25 x 3.78 in. / 285 x 235 x 96 mm) Return Air: MERV8 (11.2 x 9.25 x 3.78 in. / 285 x 235 x 96 mm) Outside Air & Return Air (Nominal): 11.25 x 9.25 x 3.75 in	
Preheater	Integrated Preheater for Frost Prevention	
Core Bypass	PID Bypass Damper for Temperature Control	
Insulation & Thermal Conductivity	2" Foam @ 0.042 W/mK / 0.024 BTU/(hr ft °F); 0.8mm Galvanized Steel Inner/Outer Casing	
Duct Connection	9.84" x 5.91" / 250 mm x 150 mm; Diameter 7.87" / 200 mm Nominal: 10" x 6"; Diameter 8"	
Operation Modes	CAV, DCV, VAV, BMS, Economizer (Freecooling)	
Native BMS Connectivity	Modbus (TCP & RTU) & BACnet/IP Compatible. Points Available Upon Request	
Certifications	TUV SUD (UL 1812, CSA 22.2 No. 113) Pending Passive House Pending FCC Class A	
Sensors	Temperature (10Kohm NTC Thermistors): Outside Air, Supply Air, Supply Duct, Return Air, Exhaust Air Pressure: OA and RA Filter Pressure Drop Pressure Differential of Supply to Atmosphere (VAV)	
Optional Accessories Provided by Ventacity	External Outside Air and Exhaust Air Damper Modules External DX or WCO Postheater Modules Internally Mounted CO2 Sensor (Room CO2 Sensor Recommendations Available) External Condensate Pump, External Condensate Ball Siphon	

ELECTRICAL

**Preheater	Inactive	Inactive	Active	Active
Voltage	240 VAC	208 VAC	240 VAC	208 VAC
Phase	1Φ	1Φ	1Φ	1Φ
Power Supply	270 W	270 W	1.78kW	1.41 kW
FLA – Max	1.1 A	1.3 A	7.4 A	6.8 A
MCA	1.2 A	1.4 A	9 A	8.2 A
MOP	5 A	5 A	10 A	10 A
De-Ice Preheater	-	-	1.51 kW	1.14 kW
Preheater Temp Rise	-	-	11.3° C	8.5° C
Max Power per Fan	125 W (0.17 hp)			

**Preheater recommended for below freezing outdoor temperatures



> DIMENSIONS (IN.)

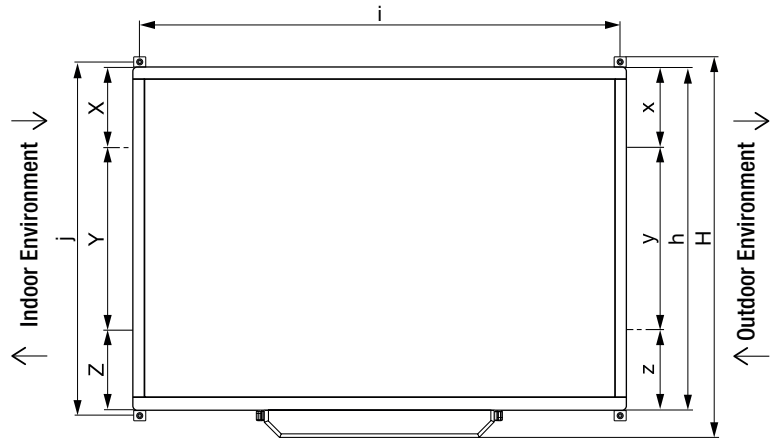
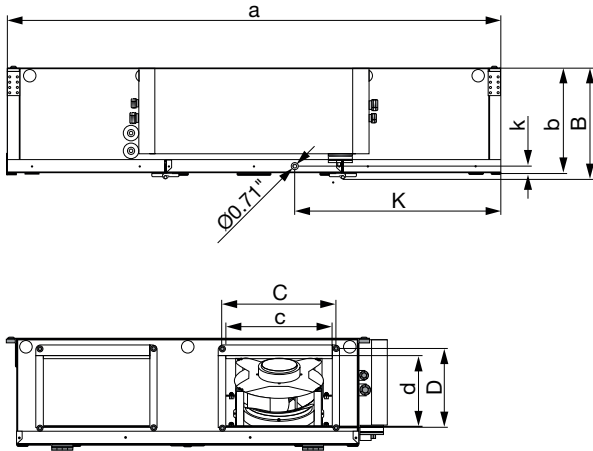

H 30.71	b 11.81	k 0.83	D 6.85	y 13.07
h 26.38	i 44.09	c 9.84	X 6.54	Z 6.54
a 46.85	j 27.56	d 5.91	x 6.54	z 6.54
B 12.20	K 19.09	C 10.79	Y 13.07	

> FAN OPERATING RANGE

60 – 250 CFM
0 – 2.0" W.C. ESP

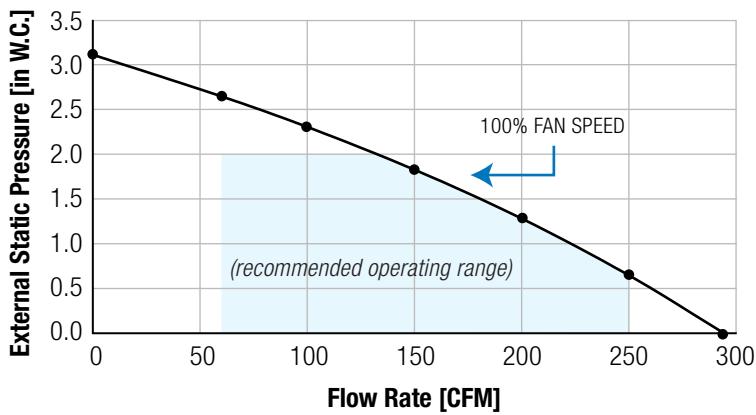

> PARTS

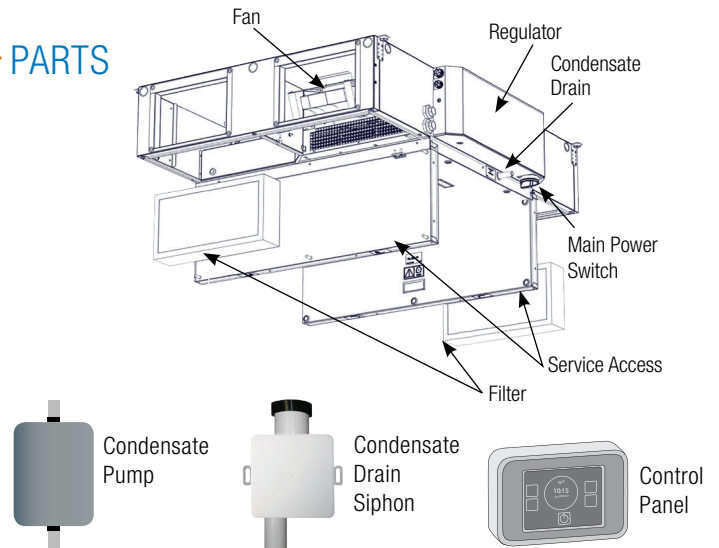

> HEAT RECOVERY EFFICIENCY

AHRI 1060 Standard Conditions

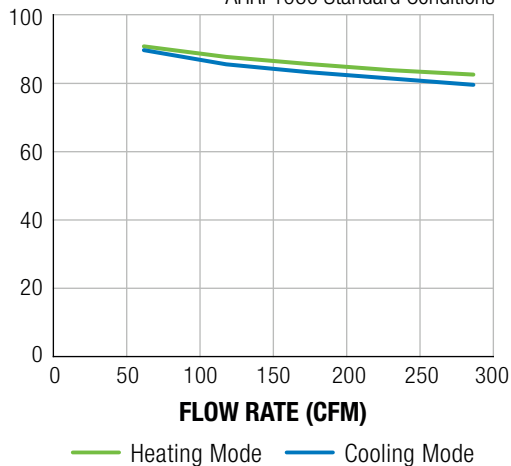

> FAN VOLUME

Ext. Static Pressure (in. W.C.)	0.67	1.30	1.85	2.33	2.67
Maximum Flow (CFM)	250	200	150	100	60
System Power (Watts)	245	253	253	244	229

> FAN POWER*

Airflow (CFM)	250	200	150	100	60
CFM/WATT (2 Fans)	1.6	2.1	2.6	2.9	2.5
System Power (Watts)	175	117	78	55	44

* at 1/8" water column

Limited Warranty Ventacity Systems Equipment

1.
 - a) **PARTS WARRANTY** – Ventacity Systems, Inc. warrants to the original end user of this product that should this product prove defective due to improper workmanship and/or material under normal use for a period of two years from the date of installation for commercial applications and for five years from the unit date code for residential applications. Ventacity Systems, Inc. will repair or replace, at its option, any defective part without charge for the part. Replacement parts are warranted for the remainder of the original warranty period.
 - b) **THIS WARRANTY DOES NOT INCLUDE LABOR** or other costs incurred for servicing, repairing, removing, installing, shipping or handling of either defective or replacement parts, or complete unit. Such costs may be covered by a separate warranty provided by the installer.
 - c) **EXTENDED 10-YEAR CORE WARRANTY** – Should the energy recovery core prove defective due to improper workmanship and/or materials for a period of 10 years from the unit's date code, Ventacity Systems, Inc. will repair or replace core at no charge. The repair/replacement shall be warranted for the remainder of the original warranty period. **LABOR AND OTHER COSTS ARE NOT INCLUDED** – See (b) above.
 - d) **NOTICE.** To obtain warranty services and/or parts replacement, you must notify a qualified Ventacity dealer or contractor of any defect within the applicable warranty period.
2. Any defective part to be replaced must be made available to Ventacity Systems, Inc. in exchange for the replacement part. You must present proof of the original date of installation of the product or proof of the unit date code in order to establish the effective date of the warranty.
3. **TO OBTAIN WARRANTY SERVICE**, please contact your dealer or contractor who installed this product. If your dealer or contractor needs assistance, his distributor is available for consultation, and Ventacity Systems, Inc. supports his distributor's efforts.
4. This limited warranty applies only while the unit remains at the site of the original installation (except for mobile home installations) and only to units installed within the continental United States, Alaska, and Hawaii. This limited warranty applies only if the unit is installed and operated in accordance with Ventacity Systems, Inc.'s instructions and in compliance with applicable local installation and building codes and good trade practices.
5. **THIS WARRANTY DOES NOT COVER** damages caused by: (a) accident, abuse, negligence, or misuse; (b) operating the product in a corrosive atmosphere containing chlorine, fluorine or any other damaging chemicals; (c) modification, alteration, repair or service by anyone other than an authorized Ventacity dealer or contractor; (d) improper matching or application of the product or components; (e) failure to provide proper maintenance and service to the product according to manufacturer's instructions; (f) installation or operating of the product in a manner contrary to the instructions of the manufacturer; (g) lightning, fluctuations in electrical power or other acts of God. This limited warranty also excludes all costs of installation, disconnection or dismantling the product, parts used in connection with normal maintenance such as filters or belts and owner-required maintenance. Consult the instructions enclosed with the product for information regarding recommended maintenance.
6. No one is authorized to change this **LIMITED WARRANTY** in any respect, or to create for use any other obligation or liability in connection with this product.
7. **YOUR ONLY REMEDIES ARE PROVIDED IN THIS LIMITED WARRANTY. ANY EXPRESS WARRANTY NOT PROVIDED HEREIN, AND ANY REMEDY WHICH, BUT FOR THIS PROVISION, MIGHT ARISE BY IMPLICATION OR OPERATION OF LAW, IS HEREBY EXCLUDED AND DISCLAIMED. THE IMPLIED WARRANTIES OF MERCHANTABILITY AND OF FITNESS FOR ANY PARTICULAR PURPOSE ARE EXPRESSLY LIMITED TO A TERM OF ONE YEAR FROM THE DATE OF ORIGINAL INSTALLATION. UNDER NO CIRCUMSTANCES SHALL VENTACITY SYSTEMS, INC. BE LIABLE TO THE OWNER OR ANY OTHER PERSON FOR ANY INCIDENTAL, SPECIAL OR CONSEQUENTIAL DAMAGES IN CONNECTION WITH THIS PRODUCT, WHETHER ARISING OUT OF BREACH OF WARRANTY, BREACH OF CONTRACT OR OTHERWISE.**
8. Some states do not allow limitations on how long an implied warranty lasts or do not allow the exclusion or limitation of incidental, special, or consequential damages, so the above limitations or exclusions may not apply to you.
9. This warranty gives your specific legal rights, and you may also have other rights that vary from state to state. This warranty is valid only in the U.S.A. and is not transferable.